

SOOKE

MULTIPURPOSE

COMMUNITY

FACILITY

Prepared for: Getting it Built

Prepared by: Sooke Community Arts Council

June 22, 2014

draft 5

VISIONING STATEMENT, PRESENTED BY SOOKE COMMUNITY ARTS COUNCIL 2014



Objective

Our objective is to secure demographically inclusive multifunctional and specialized artist studio spaces to accommodate the community's involvement in the active process of creating and being involved in the arts. This

A direct benefit of the morphing design will be the ability to accommodate other community groups for meetings, fundraising events and gatherings.

List of Sooke Area Arts Groups and SCAC user groups this proposal has the ability to directly impact:

Journey middle school string band - 20 children

Pacheedaht early childhood education - 20 children

TAG - Unknown

All Sooke Arts and Crafts - 72

Sooke Fine Arts Society - *unknown*

Sooke Philharmonic Symphony - 60 statistics from the web site

Sooke Philharmonic Corus - 30 statistics from the web site

Sooke Harbour Players - current 90, in the past 4 years has been as high as 400 fluctuates with the productions;
60% adult, 40% youth

Sooke Writers Collective - Adults 15 and youth outreach

Sooke Area Fine Artists - 78 independent local visual arts artists - adults that we have on our mailing list, there are more

Sooke Dance Studio - 230, 75% 1 - 12 YRS, 20% 13 - 18 YRS, 5% 19+ YRS

Sooke Folk Music Society - *unknown*



Project Outline

Secure a location and the commitment of local user groups, develop a funding strategy, contact private and government agencies for funding options, conduct a community survey, and build a “Community Arts, Cultural and Activity Centre for Sooke” build it and we will grow. Approximate funding based on similar projects through out the lower mainland 6 million which includes multi use areas.

Sooke has the youngest average age of any community on Vancouver Island, and continues to be attractive to young families due to the value of housing prices, shown by large number of children.

Sooke, DM – Age distribution

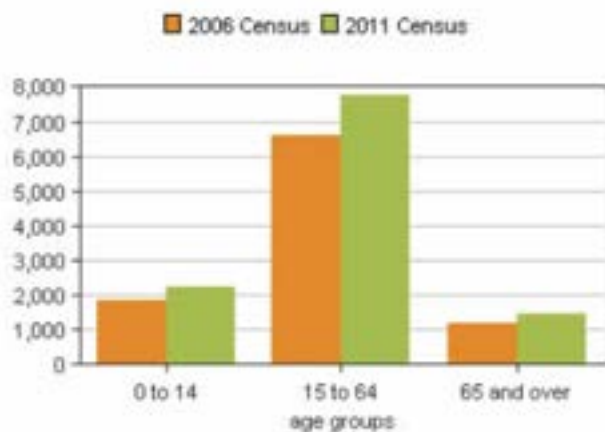

Table 4 Sooke, DM – Age distributions by broad age groups and sex, 2011 Census

Age groups	Both sexes	Males	Females
0 to 14	19.4%	19.8%	18.9%
15 to 64	67.9%	68.1%	67.8%
65 and over	12.7%	12.2%	13.3%

In 2011, the percentage of the population aged 65 and over in Sooke, DM was 12.7%, compared with a national percentage of 14.8%. The percentage of the working age population (15 to 64) was 67.9% and the percentage of children aged 0 to 14 was 19.4%.

In comparison, the national percentages were 68.5% for the population aged 15 to 64 and 16.7% for the population aged 0 to 14.



From the 2006 - 2011 census the greatest increase in demographic population is in the 15- 64 age bracket, and our current percentage of children, birth up to age 15 in our population is almost 3% higher than the national average.

Goals

This community art and cultural centre involves much more than drawing pretty pictures. It is a vital link to local culture and economic growth. It offers education for adults and youth, the disabled and seniors. It also offers important therapy from our stressed lives. Art centres have the potential as a venue for its artist members to sell, perform and demonstrate their skill. An art centre is a wonderful place to interact with peers as well as having different aspects of the population meet, interact and learn from each other..

The arts in Sooke have never had a home. Many of our arts groups have managed to eek out small spaces, rely on the donation of homes of members, studio facilities, and the donation and generosity of facilities from private businesses such as Sooke Harbour House, cafe's and coffee shops. The arts in Sooke need infrastructure; a place to call home. While we compiled information for this presentation it was common to hear from groups, "we would have a larger membership if we had a home" we have never had any kind of facility, yet have managed to not disappear and have managed to continue to create events and activities for the entire community to take part in.

Children's art programs and art camps should be easily accessible, and centrally located. Many of our resident artists have tried various ways to accommodate the local population and have often met with a lack of support from the current infrastructure in our community. Art tends to be an active and sometimes inter-active process and requires a combination of private and public space in order for it to unfold. Space is needed so that classes and groups will not interfere with each other or smaller, quieter happenings

Solution

Approximately 10,000 square feet of both permanent and flexible space with kitchen/cafe/coffee shop, space suitable for art openings and gallery shows, small scale performance, folk music events, jazz events, youth music performances, special event rentals, a gathering space, arts and cultural exchange classes with ALL the residents

of Sooke, offer learning and life enrichment in the arts opportunities to all ages and create ongoing fund raising opportunities for increased growth in the community.

What is required is app Approximately 10,000 square feet of both permanent and flexible space with room for things like:

- kitchen/cafe/coffee shop
- space suitable for art openings, gallery shows and small scale performances (folk music events, jazz events, youth music performances)
- special event rentals
- a gathering space
- arts and cultural exchange classes

The centre would be for **ALL the residents of Sooke**, to offer learning and life enrichment in the arts, opportunities for all ages and to create ongoing fund raising opportunities for increased growth in the community.

The programs aim to introduce arts and culture programs to residents of all ages. We will work with other community, provincial, and arts partners to fill gaps or needs for programs.



With the facilities there lies an opportunity where the arts can play a crucial and valuable role in the local community economic development efforts. The resulting effects are both indirect and direct.

The Indirect effects of arts-based community development approaches are: the amenities and aesthetics of a community are increased to enhance its overall image and, consequently, attract additional growth and development (*Phillips,*

1998, p. 5). The more evident direct effects include increased economic activity in terms of jobs, sales, and public revenues. As a study of the role of arts in community economic development has indicated, most communities consider that the principal economic importance of the arts industries lies in their capacity to generate employment against a backdrop of recession and restructuring (*Williams et al., 1995, p. 74*).

Art and Cultural programs have been proven over and over to full fill needs in our social network that creates our communities. For years there have been studies done on at risk youth and the positive impact of having arts programs accessible to them.

With population shifts there have recently been more studies regarding the affects of arts administered programs to the senior population with astounding early results. (Adendum C; **The Creativity and Aging Study** The Impact of Professionally Conducted Cultural Programs on Older Adults Final Report: April 2006)

“In conclusion, these results point to powerful positive intervention effects of these community-based art programs run by professional artists. They point to true health promotion and disease prevention effects. In that they also show stabilization and actual increase in community-based activities in general among those in the cultural programs, they reveal a positive impact on maintaining independence and on reducing dependency. This latter point demonstrates that these community- based cultural programs for older adults appear to be reducing risk factors that drive the need for long-term care.”

Physical Requirements

These requirements are noted as all being individual space, once we are further along many of the groups that can and will be able develop cohesive symbiotic relationships and work from one morphing location in the building.

- Theater space for performance arts, suitable for small productions and to allow for rehearsals. 2000sq ft

The current situation is that *(Performance art groups currently collaborate and share props, tech equipment, dancers/actors/singers with Sooke Harbour Players and Sooke Youth Choir so being part of a community Art proposal would be great. We are talking about buying our own tech equipment separate from the community theatre that we all can use. The school district has so much control over the theatre and theatre equipment that our groups tend to get left in the lurch far to often - especially when we pay and invest into the equipment and theatre and still have little or no say or control)*

Climate controlled storage for valuable set and costumes (Costumes/props, 1000 ft; Meetings/Historical ,500 ft; Sets, 1000 ft)

Community storage of this type of equipment is badly needed.

- Performance/dance studio with spring floor, mirrors and a barre alternate use; yoga, fitness, karate, judo, etc; 2000 sq ft
- Acoustic room for music, 1000 sq ft
- Ceramic studio, 1000 sq ft, exterior shelter for atmospheric kilns ,
- Glass studio, 1000 sq ft, hot shop, cold working room, lamp working area
- Wood shop 1000 sq ft
- Metals shop 1000 sq ft

- Fibre Arts 1000 sq ft
- Three or Four multipurpose studios with sinks, windows and lighting storage for donkeys and easels, art supplies and materials, Fibre Arts, Print Making, Silk Screening, paper mache' Photography, all mediums for painting. 800 sq ft each
- One closed access studio space for adult artists to schedule life drawing sessions, 800 sq ft
- Digital arts room fully equipped with computers, cameras, green screen and secured built in storage for user groups. 800 sq ft

Hall ways designed to accommodate on going art show rental space, and transformable common areas.

Access to a flexible open space, for large art shows, which could also be used as a recreation gymnasium space for the majority of the year. We could see this space being utilized for Sooke size trade shows and events as well

The outside yard would be artistically developed to create a frequently used arts and crafts, festival and farmer's market space. We are confident, with the array of talented people in our area, we will have a beautiful and imaginative market area.

BUDGET

Estimate it will be a 10 million dollar project

potential funding ideas

Creative funding opportunities; include but are not limited to the following

Description	Quantity	Unit Price	Cost
named brick in the walk way	5000	\$ 100	\$ 500,000
room naming	10	\$ 50,000	\$ 500,000
building name;	1	\$ 500,000	\$ 500,000

Description	Quantity	Unit Price	Cost
Total			\$ 1,500,000

Events, festivals, arts shows, auctions, gifts in kind, commercial partners, (EA arts, Microsoft, Apple, Disney, Arts school satellites, Telus community funding, TD canada community funding, Community Arts Grants, Federal/Provincial infrastructure arts and cultural grants. Grants for the Youth in arts and culture, bc transit authority (big funder for cedarhill), building naming, room naming, .

Operational considerations;

Shared office space for all groups involved in the centre. A minimal staff to manage the booking, information and payment for use of the facilities and overall operations.

The facility would be rented out to local and outside user groups. Local user groups would benefit from lower rates, but would be enough to cover costs.



Operate through Memberships and facility run programs that would benefit the community such as summer camps, youth arts drop ins, and varied programming with the materials and facilities to accommodate as many of the arts as possible, and build more in the future.

Arts and cultural exchanges, we have a diverse community which has a lot to offer through cultural sharing and celebration enabling us to build a stronger more respectful community. an option is to Explore the potential of a partnership with Seaparc/crd

- Revenue generating Opportunities:
- Festivals, Markets
- Workshops
- Ongoing arts classes
- Rentals, activity subletting; yoga, jazzercise, community group meetings
- Art exhibits, gallery rentals
- Tourism arts/adventure programs

- Performing arts events
Festivals

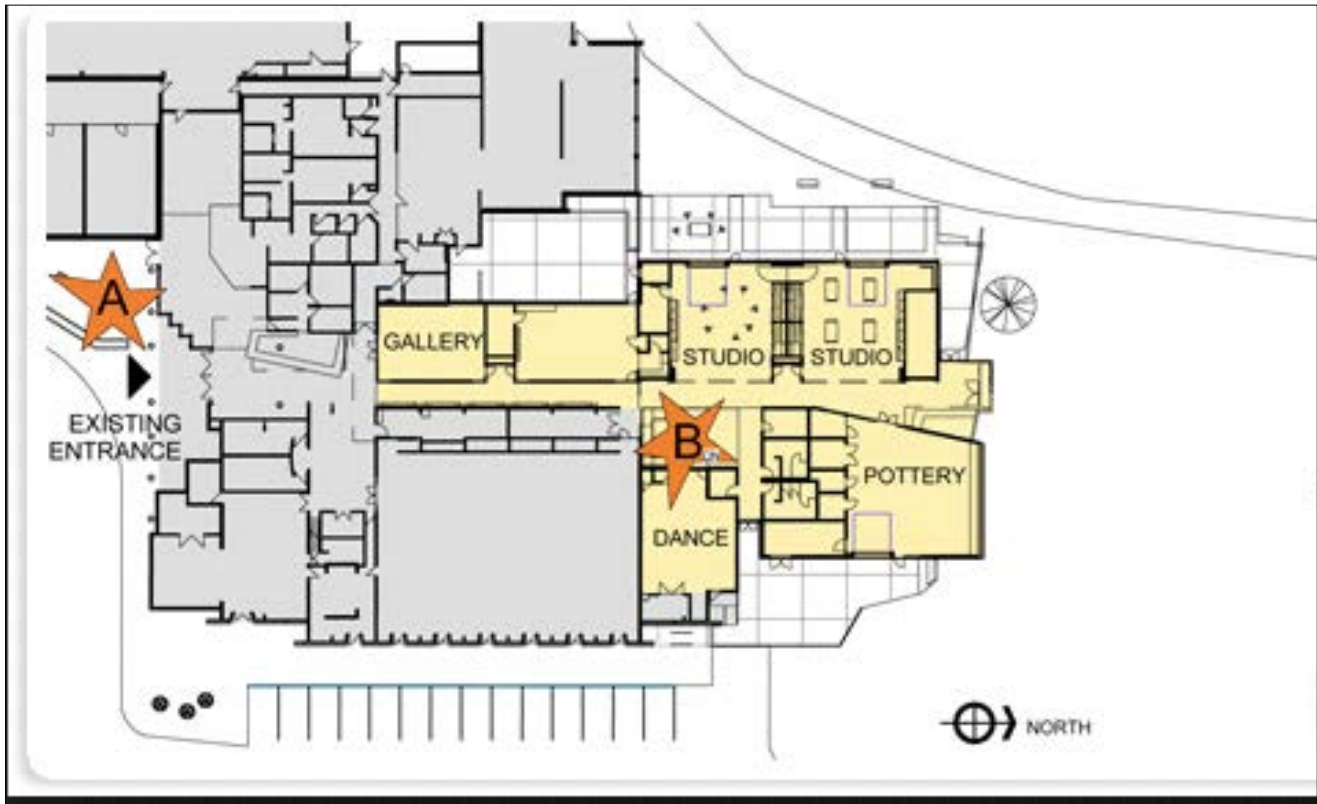

Markets

SAMPLE FACILITIES

Cedar Hill Arts Centre - <http://www.saanich.ca/parkrec/Recreation/arts/index.html>

Kelowna - Rotary Centre for the Arts - <http://www.rotarycentreforthearts.com>

Shadbolt Centre for the arts - <http://www.burnaby.ca/Things-To-Do/Arts-and-Heritage/Shadbolt-Centre-for-the-Arts/Arts-Programs/Arts-Programs-Events.html>

Richmond Art and Cultural Centre - <http://www.richmond.ca/culture/centre/about.htm>

ADDENDUM'S AND REFERENCES;

Sooke Demographic Statistics; <http://www12.statcan.gc.ca/census-recensement/2011/as-sa/fogs-spg/Facts-csd-eng.cfm?LANG=Eng&GK=CSD&GC=5917052>

Addendum A: Phillips, Rhonda. Concept Marketing for Communities: Capitalizing on Under Utilized Resources to Generate Growth and Development. Westport, Connecticut: Greenwood Press, 2002.

Phillips, Rhonda. Art as a Small Business Development Approach. Gainesville, Florida: University of Florida Centre Adendum for Building Better Communities, 1998.

Addendum B: Proposal To Lease Kaltasin Works Yard - Randy Welters, Marion DesRochers

Addendum C: PROJECT TITLE: The Creativity and Aging Study

The Impact of Professionally Conducted Cultural Programs on Older Adults Final Report: April 2006

Addendum D: Youth at Risk study, National Endowments for the Arts Society

Addendum E: Sample rental rates from similar functioning arts centre

additional information;

<http://www1.uwindsor.ca/criticalsocialwork/do-community-arts-programs-promote-positive-youth-development>

<http://vancouver.ca/files/cov/arts-health-seniors-project-full-report.pdf>